

**BioDolphin**  
Suction Kit



## Important notice

This instrument is designed for laboratory usage only. Please read this manual carefully before installing or operating this equipment. The instrument shall not be modified in any way. Any modification will void the warranty and may result in potential hazard. We are not responsible for any injury or damage caused by any non-intended purposes and modifying the instrument without authorization.

1. Please study this instruction manual carefully before using this product.
2. Please discard packing material according to related regulations.
3. Rack and water catchment tray are not autoclavable. Please clean by following maintenance method.
4. Please clean the tubing, accessories and rack according to the maintenance method after every use.
5. Please use fluoro rubber material for the replacement of o-ring. This product is not applicable to high concentrated acid, base, organic solution

## Unpacking



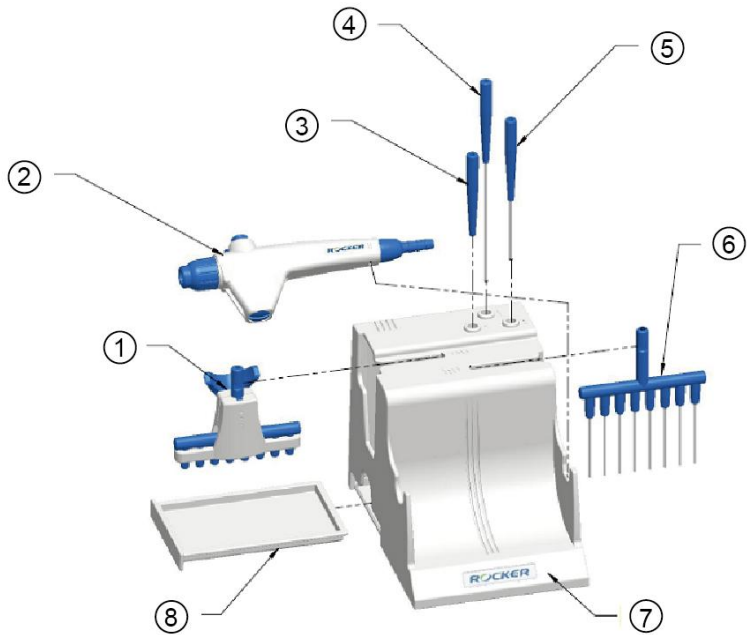

When unpacking, notice if the BioDolphin suction kit is in good situation. If not, please contact the distributor or contact us by e-mail: [export@rocker.com.tw](mailto:export@rocker.com.tw) immediately for assistance.

## Main Part Diagram



Position	Designation
1	8-channel tip adaptor with ejector
2	Handle
3	1-channel tip adaptor
4	1-channel S.S adaptor (80mm)
5	1-channel S.S adaptor (40mm)
6	8-channel S.S adaptor (40mm)
7	Rack
8	Residual liquid collection tray

# Installation

BioDolphin	
Connect the handle and 8-channel tip adaptor with ejector and 8 tips.	
Connect the handle and 1-channel tip adaptor and 1 tip.	
Connect the handle and 1-channel S.S adaptor (40mm)	
Connect the handle and 1-channel S.S adaptor (80mm)	
Connect the handle and 8-channel S.S adaptor (40mm)	

Please install the handle and adaptor according to your application

## Operation

### BioDolphin

Connect the air outlet with a vacuum pump and waste bottle by high pressure tubes.



After turn on the vacuum pump, you can press the bottom to do operation.



You can press the lock switch to do operation continuously.



You can press the ejector bottom to eject tips.



## Maintenance

1. Please clean the tubing by pure water and wipe the accessories with a dry cloth after every use.
2. After finishing the experiment, you can autoclave the used adaptor and handle at 121°C for at least 30 minutes.

**Caution: Rack and water catchment tray are not available for autoclave. Please rinse with pure water or 75% alcohol.**

3. If the stainless steel tubing is blocked, please soak in pure water for half hour and eliminate the block by L bar.
4. To ensure the air tightness of the handle, please change the rubber adaptor and O-ring (refer to the picture below) at least 1 time within 1 year.

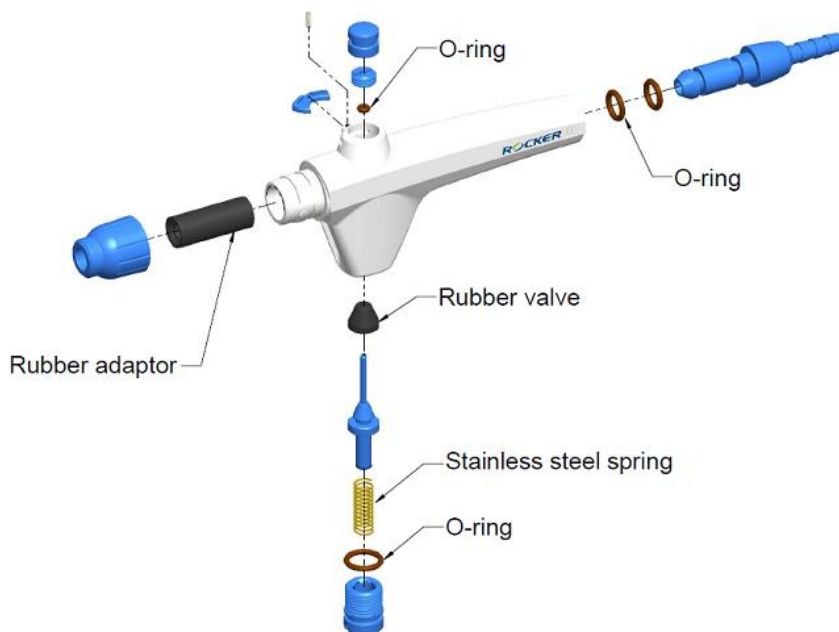

## Troubleshooting

Symptoms	Possible causes and Solution
<b>The suction button of handle fail to press</b>	<ol style="list-style-type: none"> <li>1. S.S. spring is broken → replace spring</li> <li>2. Handle is broken → contact your distributor for repair</li> </ol>
<b>Weak aspiration</b>	<ol style="list-style-type: none"> <li>1. Adjust vacuum to proper level or change vacuum source</li> <li>2. Air leakage from tubing → change silicone tube</li> <li>3. Air leakage form handle → change rubber adaptor or O-ring</li> <li>4. Handle or adaptor is broken → contact your distributor for repair</li> </ol>

## Ordering Information

199100-00	BioDolphin-LB, Suction kit –light blue
199110-00	BioDolphin-DB, Suction kit –deep blue
199120-00	BioDolphin-P, Suction kit –pink
199130-00	BioDolphin-G, Suction kit –green
199100-30	Handle
199100-46	1 channel tip adapter
199100-75	1 channel tip connector
199100-47	1 channel S.S. adapter (40 mm)
199100-48	1 channel S.S. adapter (80 mm)
199100-49	8 channel S.S. adapter (40 mm)
199100-50	8 channel tip connector
199100-61	Rack
199100-51	Accessories kit (include L bar, rubber adaptor, S.S. spring)
199100-68	Silicone tube (Φ4.2 mm x Φ8 mm ), 200 cm
199100-53	O-ring kit (include O-ring P7, O-ring AS004, O-ring AS012, rubber adaptor and valve)